

## Rotulas SI

### BEF1-1-21-502-DURBAL - BEF1-1-21-502-DURBAL

<https://www.123rodamiento.es/rodamiento-cojinete/rotulas/si/bef1-1-21-502-durbal>

#### BEF1/1-21-502



**rod end housing:**  
forged steel, tempered, surface galvanized, free of Cr-VI

**joint ball:**  
ball bearing steel, hardened and ground, surface superfinished and chromium plated

**race:**  
nylon / teflon / glass fibre compound

**tolerances:**  
see page 10

**DURBAL® heavy-duty rod ends with integral spherical plain bearing**

**female thread:**  
maintenance free, dimensions in inches

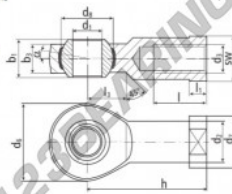

order number		measurements [inches]									
type	right hand thread	left hand thread	d <sub>1</sub>	d <sub>2</sub>	d <sub>3</sub>	class 2	d <sub>5</sub>	d <sub>7</sub>	d <sub>8</sub>	b <sub>1</sub>	b <sub>2</sub>
BEF 1/1 -21		-502	1.000	1.319	1.0000-14 UNS	2.362	1.654	1.688	1.220	.866	
		measurements [inches]									
type	h	l	l <sub>1</sub>	l <sub>2</sub>	l <sub>3</sub>	SW	α <sub>1</sub> [°]	α <sub>2</sub> [°]	weight [kg]	basic load rating C <sub>0</sub> [N]	stat. C <sub>0</sub> [N]
BEF 1/1	3.720	1.653	.511	1.200	1.417	15.5	10.0	0.663	45350	118600	

## CARACTERÍSTICAS DEL PRODUCTO

Marca	DURBAL
Nº Ean13	3663952510651
Diámetro interior	25.4 mm
Diámetro exterior	59.99 mm
Espesor	30.99 mm
Tipo	SI
Peso	663 g
Hilo	Rosca izquierda
Lubricación	sin
Envasado	1

[contacto@123rodamiento.es](mailto:contacto@123rodamiento.es)

911 436 830

CRT4 de Lesquin 60 Rue Du Haut De Sainghin 59273 Fretin FRANCE